

ADMINISTRATIVE PLAN

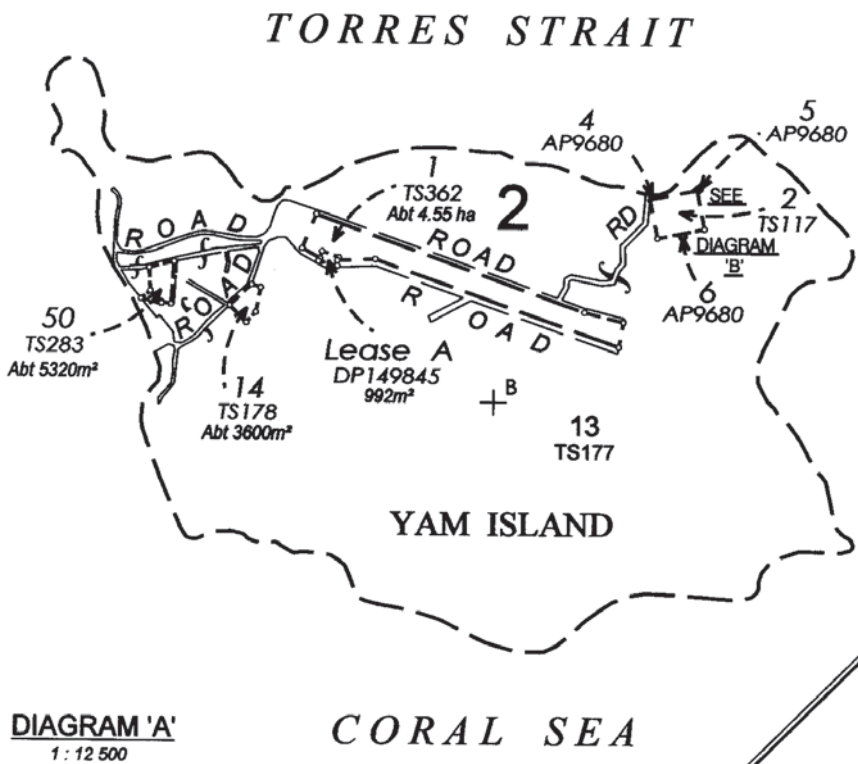

DIAGRAM 'A'
1 : 12 500

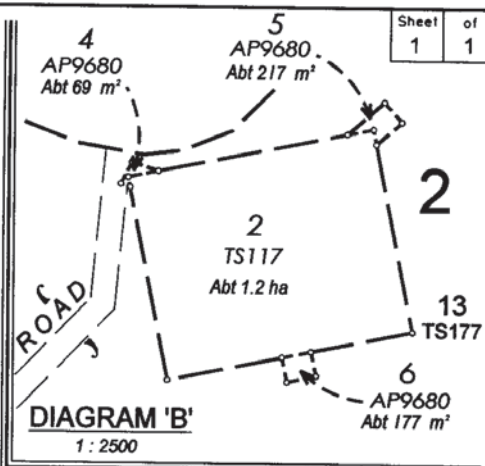
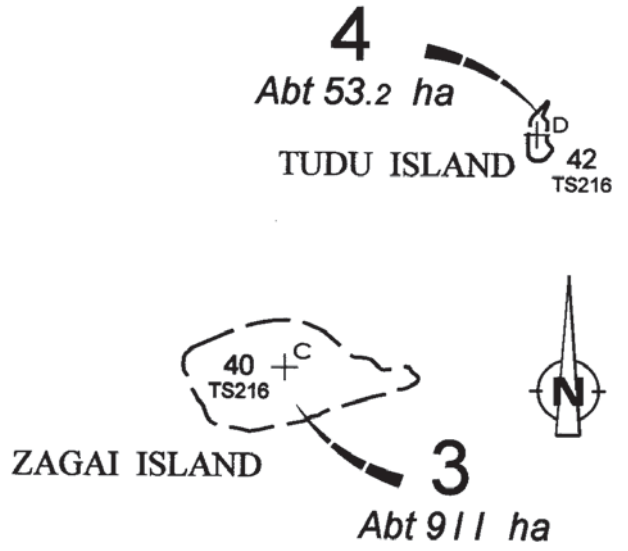
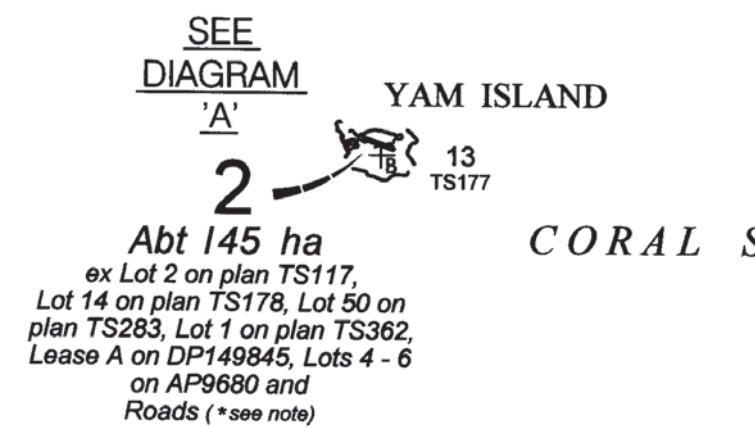
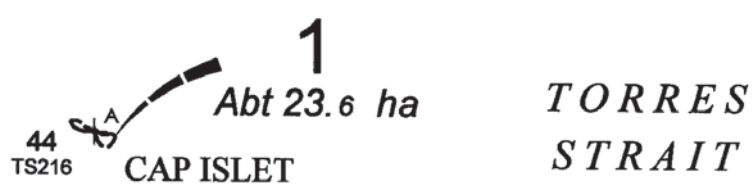

DIAGRAM 'B'
1 : 2500

I, Peter Frederick SWAN hereby certify that I have made this plan pursuant to the Survey and Mapping Infrastructure Act 2003 and Surveyors Act 2003 and associated Regulations and Standards and that the plan is accurate and compiled from plans TS117, TS177, TS178, TS216, TS283, TS362, DP149845 and DCDB extraction dated 21.03.2004 in the Department of Natural Resources and Mines and C & B Group plan 7020-27
 22.11.04
 Date Cadastral Surveyor

DETERMINED 04/05/05



Note: The boundaries of Lots 1 to 4 are determined by Ordinary High Water Mark at Spring Tides.

* Note: "Roads" means the roads shown on this plan and all other roads whether declared, notified, constructed, surveyed or taken under the laws of the Commonwealth of Australia or the State of Queensland including the common law, to be a road.

APPROX. MGA94 CO-ORDINATES

STN	EASTING	NORTHING	ZONE
A (Cap Islet)	687 850	8 912 400	54
B (Yam Island)	694 700	8 904 900	54
C (Zagai Island)	710 400	8 910 200	54
D (Tudu Island)	716 500	8 915 800	54

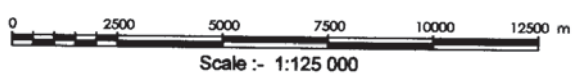

Queensland Government
 Natural Resources and Mines
 Prepared by CABOOLTURE OFFICE SOUTH EAST REGION DEPT OF NATURAL RESOURCES AND MINES LEVEL 4 33 KING STREET CABOOLTURE Q 4510
 © The State of Queensland (Dept of Natural Resources and Mines) 2004

Lots 1 - 4
 covering part of Lot 13 on plan TS177 and part of Lot 40 on plan TS216 and Lots 42 & 44 on plan TS216
 PARISH : **GIAKA** COUNTY : **Torres**
 LOCALITY : **YAM ISLAND** LOCAL AUTH : **TORRES S.C. / IAMA ISLAND COUNCIL**
 Federal Court Ref : QG 6052 / 98 NVIT Ref : QC 02 / 015 File Ref : BRI/003692
 Meridian : approx MGA94, Zone 54 Map Ref : 7478 Drawn : 11 /11 /2004

NATIVE TITLE DETERMINATION PLAN
 Scale: 1 : 125 000
 NOTE : A4 copy is reduced

AP7274